

NOTE:-
TERMINAL BOX CAN BE MOUNTED
(LEFT OR RIGHT) BY REFITTING FEET
AND LIFTING LUGS 90° IN APPROPRIATE
DIRECTIONS. CABLE ENTRY CAN BE
SUPPLIED IN ANY ONE OF FOUR
POSITIONS AT 90° INTERVALS.

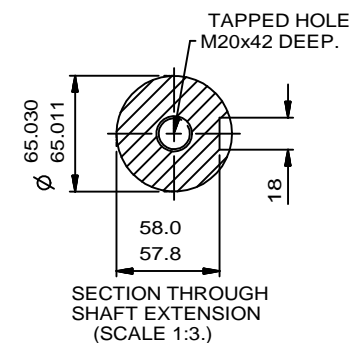

ALL DIMENSIONS IN MILLIMETERS



FIRST ANGLE
PROJECTION

**BROOK
CROMPTON**

Produced by **Tamel** a company of **NTB**

SHEET
SIZE

A3

NOTE!
2.5 ENDPLAY WILL BE PROVIDED FOR ENDTHRUST
PROTECTION WHEN CUSTOMERS NOTIFY US OF THEIR
INTENTION TO USE RIGID COUPLINGS AND DRIVEN
MACHINES WITHOUT ENDPLAY.

TITLE: OUTLINE DIMENSIONS OF STANDARD FOOT/FLANGE MOUNTED
METRIC A.C. MOTOR TO DIN STANDARD 42673 & 42677.
TOTALLY ENCLOSED FAN VENTILATED.
FRAME SIZE: WU-DF315S_E 2P. ASYMMETRICAL FEET.

	NAME	DATE
DRAWN	JM	30-06-11
CHECKED		
SCALE	1 : 8	

DRG. No. Y57GD0001T			
DRG. REF. M9313			
REVISION:		DATE:	